

THE SKETCH MAP FOR AMALGAMATION OF 1) MR. JOYDEV CHAKRABORTY, 2)MR. GOPAL CHAKRABORTY BOTH S/O - LT. RAMANIMOHAN CHAKRABORTY, RESIDENT OF CHOTONILPUR, P.O.- SRIPALLI, P.S.- BURDWAN, DIST.- PURBA BARDHAMAN, WEST BENGAL-713103, AT WARD NO- 14, AT MAHALLA- CHOTOBALIDANGA, HOLDING NO.- 270,270/A,270/B RS PLOT NO- 594, LOP NO-80, LR PLOT NO- 1082, LR KH NO- 6330,6331, JL NO-35 AT MOUZA- BALIDANGA, DIST- PURBA BARDHAMAN, P.S - BURDWAN UNDER BURDWAN MUNICIPALITY.

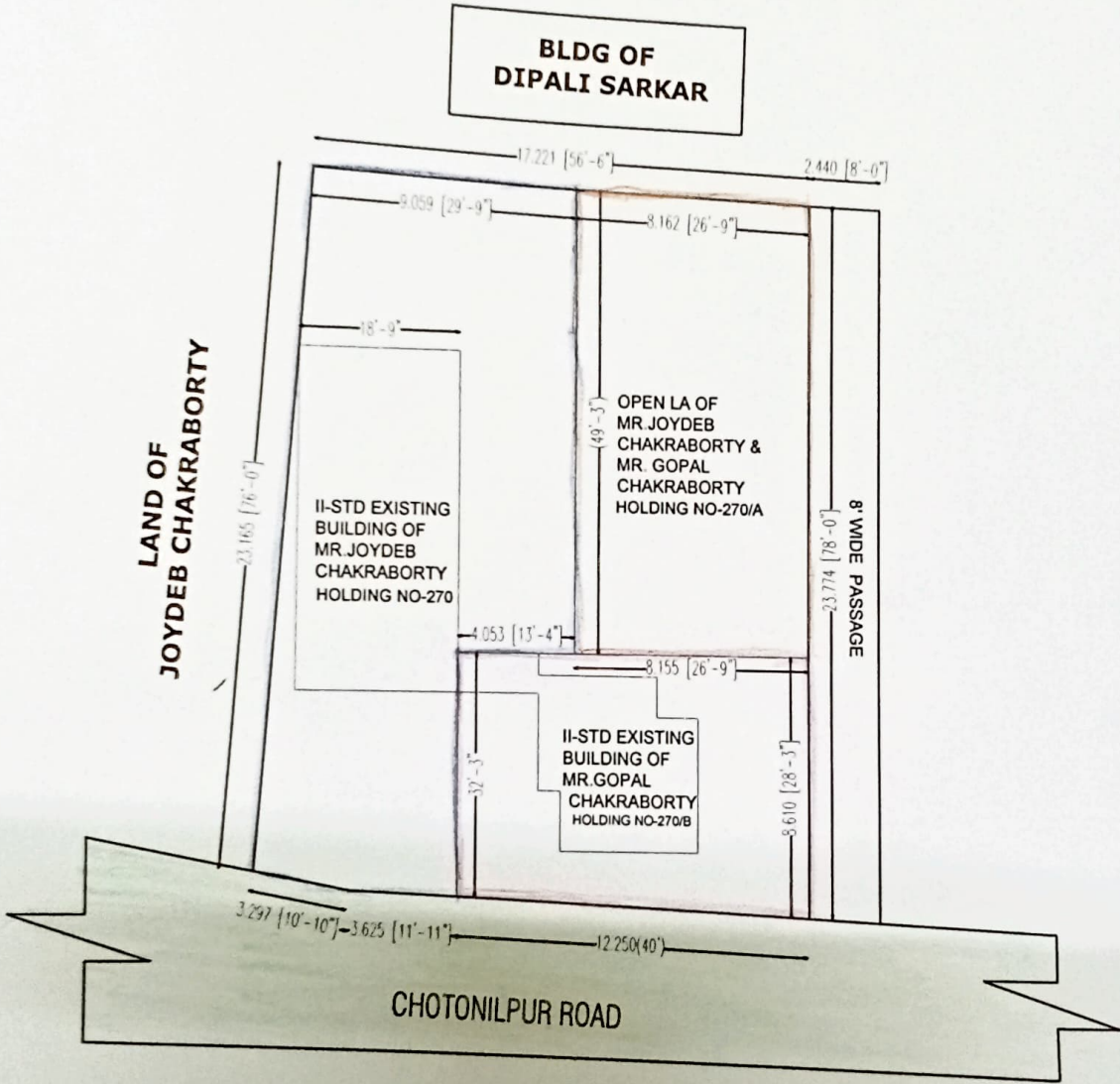

SL	NAME	HOLDING NO	AREA	COVERED AREA	OPEN AREA	TOTAL AREA
1)	JOYDEV CHAKRABORTY	270	2003 SQ FT	501 SQ FT	1502 SQ FT	= 4537 SQ FT =0.10 ACAR
2)	GOPAL CHAKRABORTY	270/B	1210 SQ FT	419 SQ FT	791 SQ FT	
3)	JOYDEV CHAKRABORTY GOPAL CHAKRABORTY	270/A	1324 SQ FT	-	1324 SQ FT	

Saurav Batbyal
SAURAV BATBYAL
 B.Tech. (Civil Engineering)
 Enlisted L.B.S. of Burdwan Municipality
 Reg. No.-BM/LBS-1/18-19/06

Joydev Chakraborty
Gopal Chakraborty

DRAWN BY

SIGNATURE OF OWNERS

বর্ধমান পৌরসভা



সংশ্লিষ্ট ব্যক্তির উদ্দেশ্যে

এতদ্বারা অবগত করা যাইতেছে যে, শ্রী/শ্রীমতী/কুমারী জয়দেব প্রসাদী- ৩

সোমেশ্বর প্রসাদী পিতা/স্বামী/ বরদী মোহন প্রসাদী

বর্ধমান পৌরসভার অন্তর্গত ২৪ নং ওয়ার্ডের ছোটগাঁও পুর-৩৬

পেচঃ শ্রীমতী/স্বামী/বর্ধমান এলাকার ~~বর্ধমান~~ স্থায়ী বাসিন্দা ও আমার বিশেষ পরিচিত।

আমার জ্ঞান ও বিশ্বাসমতে উক্ত পরিবারের মাসিক আয়

টাকা মাত্র ৬৩- জয়দেব প্রসাদী- ৩ সোমেশ্বর প্রসাদী

২৫৫১৭. নং ২৭০ এ- একটি একতল বসতঘর
বসতঘর ফাটন, মেট্রিক বহু-পুস্তক ২৫৫১৭ তাং-
মেস মোহাম্মদুল হক নাহ। বিস্তৃত হয়

কাউন্সিলার

বর্ধমান পৌরসভা

পৌরপতি/উপ-পৌরপতি/

সদস্য-পৌরপতি-পরিষদ/কাউন্সিলার

বর্ধমান পৌরসভা

33 need with Sec 29 of Indian Stamp Act I
Banker

Exemption No. 4233F Addl. District Registrar
BURDWAN

date 20.10.72

THIS INDENTURE made this 3rd day of October one

thousand nine hundred and eighty eight BETWEEN the GOVERNOR OF THE STATE OF WEST BENGAL hereinafter referred to as the "DONOR" (which expression shall unless excluded by or repugnant to the context be deemed to include his successors in office) of ONE PART; AND SHRI/SMT/KM. Ramani

Son/Wife / daughter of... Late Mohan Chakrabarty
residing at... Balidanga G. S. Colony

SHRI / SMT / KM.
Son / wife / daughter of
residing at
SHRI / SMT / KM.

Son / wife / daughter of
residing at
SHRI / SMT / KM.

Son / wife / daughter of
residing at
SHRI / SMT / KM.

Son / wife / daughter of
residing at
SHRI / SMT / KM.

Son / wife / daughter of
residing at
SHRI / SMT / KM.

Son / wife / daughter of
residing at
SHRI / SMT / KM.

hereinafter called the "DONEE" (which expression shall unless excluded by or repugnant to the context be deemed to include his/her heirs, executors, administrators, representatives and assigns) of OTHER PART.

WHEREAS after the partition of India a large number of residents of former East Pakistan crossed over and came to the territory of the State of West Bengal from time to time due to force of circumstances beyond their control.

AND whereas the Government of West Bengal (hereinafter referred to as the "Government") offered all reasonable facilities to such persons (hereinafter referred to as "Refugees") for residence in West Bengal.

AND whereas a considerable number of such people were compelled by circumstances to use vacant lands in the urban areas for homestead purposes.

AND whereas the DONEE was one of such persons who had come to use and occupy a piece of land particularly described in the schedule hereunder.

AND whereas the DONEE being a refugee displaced from East Pakistan (now Bangladesh) approached the Government of West Bengal for a plot of land for his rehabilitation.

AND whereas the Government of West Bengal with the intent to rehabilitate the Refugees from East Pakistan now Bangladesh acquired land in C.S. Dag No. 594 Part... Mouza Balidanga in Police Station Burdwan... in the District of Burdwan in the Urban area Burdwan under the provisions of L.D.P. Act, 1948/L.A. Act I of 1894 including the plot now in occupation of the DONEE. (Urban-acquired-lease-gift)

AND whereas in accordance with such request and for the purpose of rehabilitation the Government of West Bengal by a lease dated 17.2.83 demised in favour of the DONEE all the piece of land measuring 6 (Six) Cottahs... 4... Chattacks... 7... Sq. Feet be the same a little more or less recorded in C.S. Dag No. 594 Part Mouza Balidanga within the Police Station Buridwan in the District of Buridwan and more particularly described in the schedule hereunder written for a period of Ninety-nine years as from the date of the demise on the terms and conditions mentioned therein.

AND whereas it has been decided by the Government to confer absolute right title and interest by way of gift in the said demised land more fully described in the schedule hereunder written unto and in favour of the DONEE he/she having agreed to surrender his/her leasehold interest under the said deed of lease dated 17.2.83 Serial No. 1306

NOW THIS DEED WITNESSETH as follows :

1. THAT in consideration of the premises the DONEE hereby surrenders and yields up to the DONOR all that the land comprised in and demised by the herebefore in part recited lease and described in the schedule hereunder written with all buildings, structures and erection on the said land and other fixtures and fittings and the improvements made by the DONEE thereon to the intent that the terms created by the said lease and all estate and interest of the DONEE in the said land or by virtue of the said lease be absolutely and forever extinguished and the said land may revert to the DONOR with the aforesaid buildings, structures, fixtures, etc. AND the DONOR hereby releases the DONEE his/her heirs, executors, administrators from all claims, demands and liability arising under or in respect of the said land AND the DONEE hereby relinquishes all claims of compensation for any buildings, constructions and fixtures, etc. as erected and made on the said land with all fixtures and fittings.

2. NOW THIS DEED ALSO WITNESSETH that in consideration of the premises herebefore mentioned and to provide relief to the DONEE in consideration of his/her destitute condition the DONOR doth hereby absolutely give grant and transfer unto the DONEE ALL THAT PIECE AND PARCEL OF LAND more fully described in the schedule hereunder written as homestead land OR HOWSOEVER otherwise the said land hereditaments and premises are or is at any time or times heretofore were situated butted and bounded as hereinafter described TOGETHER WITH all ways, paths, passages, easements, privileges, appendages and appurtenances whatsoever with all easements thereto and therein TO HAVE AND TO HOLD THE SAID land hereditaments and premises hereby given granted and transferred unto and to the use of the DONEE forever AND the DONEE shall and may at all times hereafter peaceably and quietly possess and enjoy the said land hereby given granted and transferred subject to the condition that the DONEE shall have no-right save as hereinafter provided to alienate or transfer in any way the land comprised in the schedule hereunder written in any manner whatsoever within a period of 10 (ten) years from the date of these presents without obtaining prior written permission of the DONOR which shall not be obligatory on the part of the DONOR to give and which will be granted only in exceptional circumstances of hardship PROVIDED THAT THE DONEE shall be at liberty to mortgage charge or encumber the said land with the Life Insurance Corporation of India or any Nationalised or Scheduled Bank, Co-operative Bank or Government or any Statutory Body or Government Sponsoresd Financial Institution within this period of ten years for the purpose of construction of a residential building therein and for the purpose of better economic and physical improvement AND THE DONOR and all persons lawfully and equitably claiming as aforesaid shall and will from time to time and at all times hereinafter at the request and costs of the DONEE do or execute or cause to be done and executed all such acts deeds and things whatsoever for further better and more perfectly assuring the said message land hereditaments and premises and every part thereof unto the DONEE in the manner aforesaid as shall or may be reasonably required.

SCHEDULE

ALL THAT PIECE OR PARCEL OF LAND measuring 6 (Six Cottahs) more or less of homestead land in G/P No. 80 in C.S. Plot No. 594 Part in Khatian No. of Mouza Balidanga J. L. No. 35 P. S. Buridwan in the district of Buridwan Sub-Registration Office Buridwan butted and bounded in the manner following :

On the North Public Land

On the East Public Land

On the South L.O.P. No. 81 & 82

On the West Municipal Road

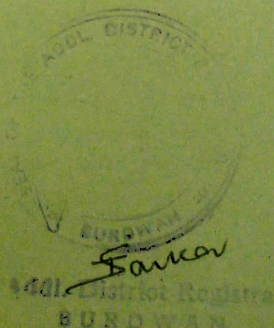

IN WITNESS WHEREOF THE DONOR and THE DONEE have hereunto set and subscribed their respective hands the day, month and year first above written.

Signed and delivered for and on behalf of the Governor
Refugee, Relief and Rehabilitation Department
Government of West Bengal

[Handwritten Signature]

By the Collector
District **Add. District Magistrate**
(A. B.) BURDWAN

in the presence of:

1st witness

Address
[Handwritten Signature]
S. D. R. R. O.
SADAR BURDWAN

2nd witness

Address
[Handwritten Signature]
Add. Rehabilitation Officer
R. R. & R. Deptt.
Burdwan (Sadar)

[Handwritten Signature]
Signed by the DONEE

1st witness **Rameshraj Majhi** Occupation **Service**

Address **Sreepathi P. & Dt. Burdwan**

2nd witness **Sevan Lal Bhattacharya** Occupation **Service**

Address **Chotanipura Road (Balidanga) P.O. Dist. Burdwan**

Checked & Prepared by

[Handwritten Signature]
R. R. & R. Deptt.
Burdwan

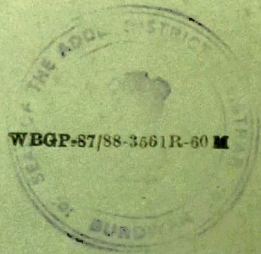

[Handwritten Signature]
District
BURDWAN



Presented for registration 12:30 P.M.

~~311~~ 3rd Oct 1908

292 30 3 88

by Ramani Mohan Chakrabarty

Execution by A.D.M. (L.R.)

is proved by ...

Sarkar
Addl. District Registrar
BURDWAN

Sarkar
Addl. District Registrar
BURDWAN



Ramani

(655) Mohan Chakrabarty

is admitted by Ramani Mohan Chakrabarty
Lt. Mangal Ch. Chakrabarty
Baidangan C.S. Colony
~~S...~~ Burdwan
Hindu

BY CAST ...
BY PROFESSION ...

(656)

(657)

IDENTIFIED Sathindran Kishore
80 Jadhav Kishore
OF ...
S... Burdwan
DIST... Burdwan
CAST... Hindu
BY PROFF... Dattin's ...

(658)

(659)

Sarkar
Addl. District Registrar
BURDWAN

Sathindran Kishore
80 Jadhav Kishore

RECORDED 9
VOLUME 729 TO 1732
PAGE FROM

Sarkar
Addl. District Registrar
BURDWAN

Government of West Bengal
Office of the Collector, Burdwan
R. M. Section.

As requested by Treasury Officer (I), Burdwan vide No. 4075 Treasury Accountant (I) dt. 23.11.90. Necessary enquires as to the legal heirs left by deceased Ramani Mohan Chakraborty who was Ex-pensioner has been held.

The information as to the legal heirs as gathered on enquiry, by the enquiring officer is as follows :-

Name of the legal heirs.	Age	Relationship with the deceased.	Address
1) Smt. Anima Chakraborty	60yrs.	wife	Chotonilpur, Burdwan.
2) Shri Mahadeb Chakraborty	35yrs.	son	- Do -
3) " Joydeb Chakraborty	33yrs.	son	- Do -
4) " Biswadeb Chakraborty	27yrs.	son	- Do -
5) Smt. Mira Chakraborty w/o Biplab Chakraborty	40yrs.	Married daughter	4, Shankaripur Burdwan.
6) Smt. Sephali Roy Chowdhury w/o Dilip Kr. Roy Chowdhury	38yrs.	- Do -	5/2 Gangadhar Banerjee Lane, Calcutta - 23
7) Smt. Dipali Sarkar w/o Bimal Sarkar	36yrs.	- Do -	4, Shankaripukur Burdwan.
8) Smt. Mitali Chakraborty w/o Sisir Chakraborty	30yrs.	- Do -	Badamtala, Burdwan.

Sdt
For Collector, Burdwan.

Memo. No. 556(2) R. M.

Dated 12-3 / 1991.

Copy forwarded to Treasury Officer (I), Burdwan with reference to his no. 4075 T. A. (I) dt. 23.11.90.

ii) ✓ Copy to :-

Smt. Anima Chakraborty
w/o Late Ramani Mohan Chakraborty
Chotonilpur
Burdwan.

For Collector, Burdwan.